



GARDEN SHEDS

High strength WPC material

Aluminum frame

Durable service, Against insects and Paint-free

湖州新峰木塑复合材料有限公司
HUZHOU XINFENG WOOD PLASTIC COMPOSITE CO.,LTD.

工場住所: 湖州市德清經濟技術開發區長虹西街187号
Factory address: No.187,West Changhong Street,Deqing Economic
Development Zone, Huzhou City,China
TEL: 0086-572-8832669
FAX: 0086-572-8832699
P.C: 313200

E-mail: xf@hzxinfeng.com http: www.hzxinfeng.com

營業部住所: 杭州市西湖区荆山岭路2号汇峰国际A棟7階
Sales Office address: 7F, Building A, Huifeng International, Jingshanling Road,
Xihu District, Hangzhou City
TEL: 0086-571-89935786
FAX: 0086-571-89935705
P.C: 310023



website



catalogue

COMPANY PROFILE

Huzhou Xinfeng Wood Plastic Composite Co., Ltd is invested by Hangzhou Xinfeng Industry Co.,Ltd. It integrates R&D,production, sales capacity for specializing in WPC production.

SINCE 1989



The company keeps putting emphasis on technology innovation, has an excellent professional R&D team, and pays close attention to intellectual property protection. Through continuous efforts and innovation, the company got over 100 patents in China, European Union, United States and other countries. In addition, the products passed many tests of SGS, INTERTEK and some other international testing organizations. The products conform to the standard of European Union. And also get the certificate of CE, FSC, BSCI, etc.



SGS

Intertek

BSCI

ISO9001

CE



REACH
SVHC



The company mainly produces WPC extrusion decking, WRC fence, WPC DIY tile, WPC garden shed, WPC wall cladding, adjustable pedestal and WPC flowerpot. These products are exported to more than 20 countries across Europe, North America, Japan and Southeast Asia.



Our Office



Testing Center



Extrusion Workshop



Injection Workshop

At the same time, the company has been committed to environmental protection, and made unremitting efforts to build a green factory, produce green products and create a green home.



The garden shed is constructed with an aluminum frame, insert plate connection and screw fastening system to ensure easy assembly and structural stability. The wall panel of our garden shed is made of wood-plastic composite material which is strong and durable. The WPC material is an environmentally friendly material. There are two kinds of normal extrusion wpc panel and co-extruded wpc panel.

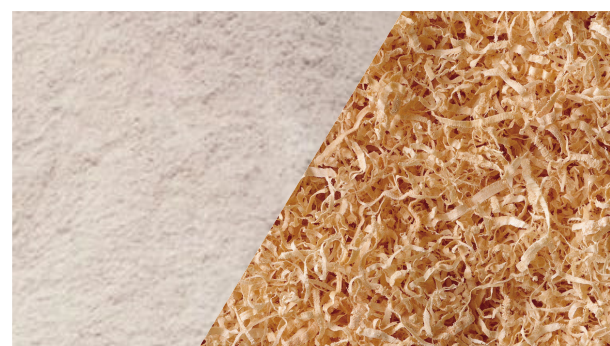

Recycled wooden powder/wooden chips



Recycled plastic

The co-extruded wpc panel has the property of water resistance and beautiful surface texture. There are two thicknesses: 19mm and 28 mm. We recommend to choose the wall panel with 28mm thickness. But if the length of the wall is within 2 meters, then you also can choose the wall panel with 19mm thickness to reduce the cost.



Co-extruded wpc panel

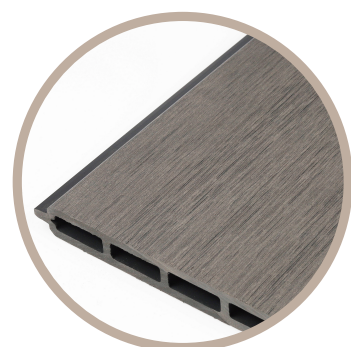

Normal extrusion wpc panel



PP panel

In addition, you can also choose a new board which is made from PP as the wall panel. It also has the property of water resistance. And what's more importance is that it has many options of the surface texture and excellent surface effect. The thickness of the PP panel is 28mm.

The roof is also made from WPC or PP panels. So the garden shed can be protected from the weather. The garden shed is also equipped with practical and pre-assembled doors and windows, which has double tempered glass, spacious dimensions and aluminum alloy frame, to ensure easy access to the garden shed and effectively keeping your belongings safe.

WPC PRODUCT ADVANTAGES

1. Using recycled materials (wood powder and plastic), green, low-carbon and economic.
2. Waterproof and moisture-resistant. It can be used to the environment that traditional wood products cannot be applied.
3. High strength, durability is better than the ordinary wooden materials.
4. It has natural woodiness surface, the color can be customized according to your needs.
5. Highly customisable. It is fairly simple to create and reflect personalized style.
6. Pollution-free, product does not contain benzene substances.
7. Anti-UV.
8. Simple installation, saving time and cost, Low maintenance.



XF-H001

2005x2005x2327mm

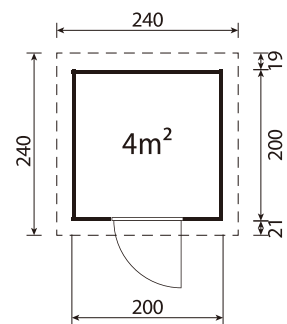
**Dimension:**

Wall panel	Co-extruded WPC panel / Normal extruded WPC panel / PP panel
Thickness of the wall panel	28 mm
Wall height	≈ 214 / 229 cm
Ridge height	≈ 232 cm
Floor area	≈ 4.0 m ²
Roof area	≈ 5.76 m ²
Roof panel	Normal extruded WPC panel / PP panel
Thickness of the Roof panel	16 mm
Roof angle	4°
Front, Side, Back overhang	21 cm, 20 cm, 19 cm
Door,	1 x 950 x 1960 mm
Opening size	822 x 1832 mm
Window	1 x 500 x 210 mm
Pallet	2500 x 1120 x 560 mm

XF-H003

2405x2405x2327mm

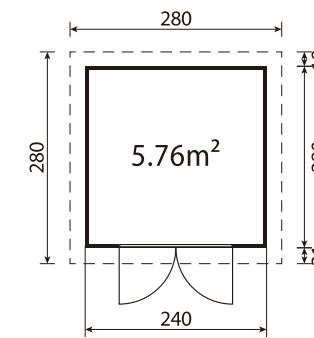
**Dimension:**

Wall panel	Co-extruded WPC panel / Normal extruded WPC panel / PP panel
Thickness of the wall panel	28 mm
Wall height	≈ 214 / 229 cm
Ridge height	≈ 232 cm
Floor area	≈ 5.76 m ²
Roof area	≈ 7.84 m ²
Roof panel	Normal extruded WPC panel / PP panel
Thickness of the Roof panel	16 mm
Roof angle	4°
Front, Side, Back overhang	21 cm, 20 cm, 19 cm
Door,	1 x 1500 x 1960 mm
Opening size	1372 x 1832 mm
Window	2 x 400 x 210 mm
Pallet	2900 x 1120 x 610 mm

XF-H002

2405x2005x2327mm

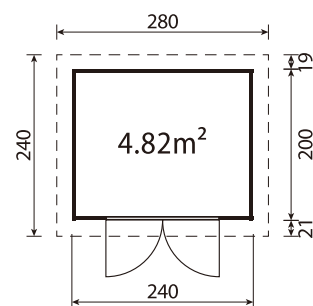
**Dimension:**

Wall panel	Co-extruded WPC panel / Normal extruded WPC panel / PP panel
Thickness of the wall panel	28 mm
Wall height	≈ 214 / 229 cm
Ridge height	≈ 232 cm
Floor area	≈ 4.81 m ²
Roof area	≈ 6.72 m ²
Roof panel	Normal extruded WPC panel / PP panel
Thickness of the Roof panel	16 mm
Roof angle	4°
Front, Side, Back overhang	21 cm, 20 cm, 19 cm
Door,	1 x 1500 x 1960 mm
Opening size	1372 x 1832 mm
Window	2 x 400 x 210 mm
Pallet	2900 x 1120 x 610 mm

XF-H004

2805x2005x2327mm

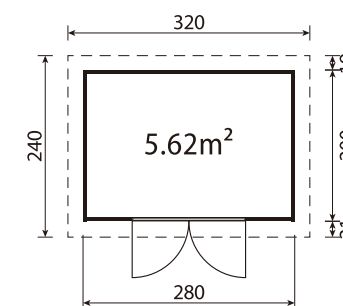
**Dimension:**

Wall panel	Co-extruded WPC panel / Normal extruded WPC panel / PP panel
Thickness of the wall panel	28 mm
Wall height	≈ 214 / 229 cm
Ridge height	≈ 232 cm
Floor area	≈ 5.62 m ²
Roof area	≈ 7.68 m ²
Roof panel	Normal extruded WPC panel / PP panel
Thickness of the Roof panel	16 mm
Roof angle	4°
Front, Side, Back overhang	21 cm, 20 cm, 19 cm
Door,	1 x 1500 x 1960 mm
Opening size	1372 x 1832 mm
Window	2 x 400 x 210 mm
Pallet	3300 x 1120 x 610 mm

XF-H005

2805x2405x2327mm

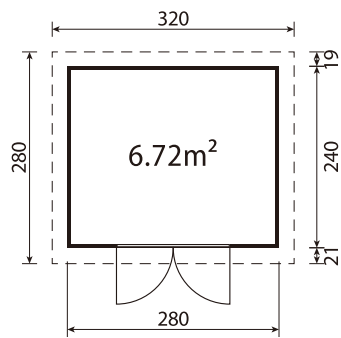

Dimension:

Wall panel	Co-extruded WPC panel / Normal extruded WPC panel / PP panel
Thickness of the wall panel	28 mm
Wall height	≈ 214 / 229 cm
Ridge height	≈ 232 cm
Floor area	≈ 6.72 m ²
Roof area	≈ 8.96 m ²
Roof panel	Normal extruded WPC panel / PP panel
Thickness of the Roof panel	16 mm
Roof angle	4°
Front, Side, Back overhang	21 cm, 20 cm, 19 cm
Door,	1 x 1500 x 1960 mm
Opening size	1372 x 1832 mm
Window	2 x 400 x 210 mm
Pallet	3300 x 1120 x 610 mm

XF-H007

2885x5195x2470mm

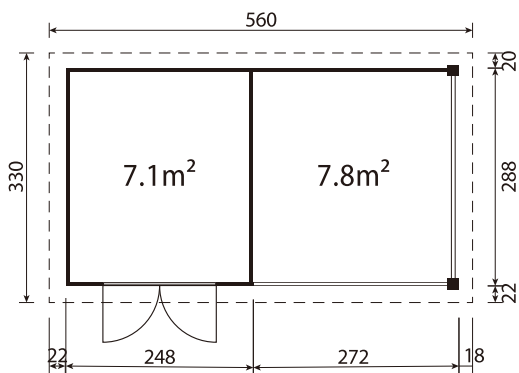

Dimension:

Wall panel	Co-extruded WPC panel / Normal extruded WPC panel / PP panel
Thickness of the wall panel	28 mm
Wall height	≈ 210 / 225cm
Ridge height	≈ 247 cm
Floor area	≈ 14.9 m ²
Roof area	≈ 18.4 m ²
Roof panel	Normal extruded WPC panel / PP panel
Thickness of the Roof panel	16 mm
Roof angle	3°
Front, Side, Back overhang	22 cm, 23 cm, 20 cm
Door,	1 x 1500 x 1960 mm
Opening size	1372 x 1832 mm
Window	1 x 900 x 506 mm 2 x 400 x 210 mm
Pallet	3400 x 1120 x 850 mm

XF-H006

2805x2805x2327mm

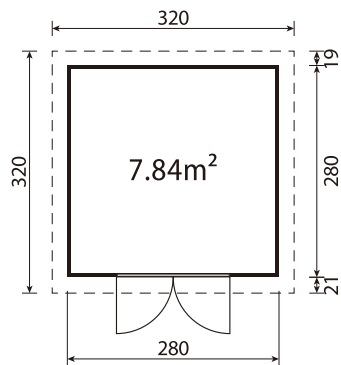

Dimension:

Wall panel	Co-extruded WPC panel / Normal extruded WPC panel / PP panel
Thickness of the wall panel	28 mm
Wall height	≈ 214 / 229 cm
Ridge height	≈ 232 cm
Floor area	≈ 7.84 m ²
Roof area	≈ 10.2 m ²
Roof panel	Normal extruded WPC panel / PP panel
Thickness of the Roof panel	16 mm
Roof angle	4°
Front, Side, Back overhang	21 cm, 20 cm, 19 cm
Door,	1 x 1500 x 1960 mm
Opening size	1372 x 1832 mm
Window	2 x 400 x 210 mm
Pallet	3300 x 1120 x 610 mm

XF-H008

2885x5595x2470mm

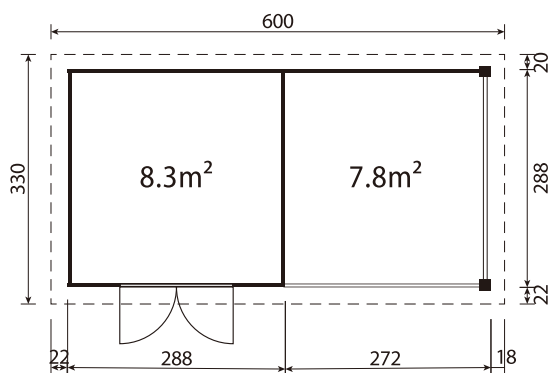

Dimension:

Wall panel	Co-extruded WPC panel / Normal extruded WPC panel / PP panel
Thickness of the wall panel	28 mm
Wall height	≈ 210 / 225cm
Ridge height	≈ 247 cm
Floor area	≈ 16.1 m ²
Roof area	≈ 19.8 m ²
Roof panel	Normal extruded WPC panel / PP panel
Thickness of the Roof panel	16 mm
Roof angle	3°
Front, Side, Back overhang	22 cm, 23 cm, 20 cm
Door,	1 x 1500 x 1960 mm
Opening size	1372 x 1832 mm
Window	1 x 900 x 506 mm 2 x 400 x 210 mm
Pallet	3400 x 1120 x 850 mm

XF-H009

2005x2005x2533mm

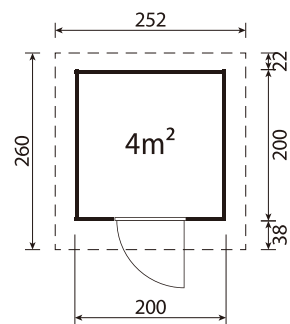
**Dimension:**

Wall panel	Co-extruded WPC panel / Normal extruded WPC panel / PP panel
Thickness of the wall panel	28 mm
Wall height	≈ 214 / 250cm
Ridge height	≈ 253 cm
Floor area	≈ 4.0 m ²
Roof area	≈ 6.96 m ²
Roof panel	Normal extruded WPC panel / PP panel
Thickness of the Roof panel	16 mm
Roof angle	21°
Front, Side, Back overhang	38 cm, 26 cm, 22 cm
Door,	1 x 950 x 1960 mm
Opening size	822 x 1832 mm
Window	1 x 500 x 210 mm
Pallet	2700 x 1120 x 580 mm

XF-H011

2405x2405x2614mm

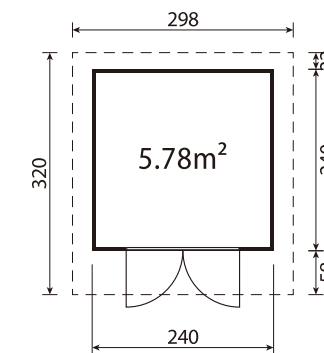
**Dimension:**

Wall panel	Co-extruded WPC panel / Normal extruded WPC panel / PP panel
Thickness of the wall panel	28 mm
Wall height	≈ 214 / 258 cm
Ridge height	≈ 261 cm
Floor area	≈ 5.78 m ²
Roof area	≈ 10.1 m ²
Roof panel	Normal extruded WPC panel / PP panel
Thickness of the Roof panel	16 mm
Roof angle	21°
Front, Side, Back overhang	58 cm, 30 cm, 22 cm
Door,	1 x 1500 x 1960 mm
Opening size	1372 x 1832 mm
Window	2 x 400 x 210 mm
Pallet	3300 x 1120 x 630 mm

XF-H010

2405x2005x2614mm

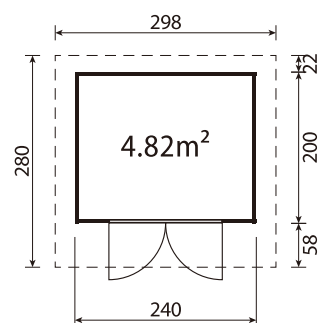
**Dimension:**

Wall panel	Co-extruded WPC panel / Normal extruded WPC panel / PP panel
Thickness of the wall panel	28 mm
Wall height	≈ 214 / 258 cm
Ridge height	≈ 261 cm
Floor area	≈ 4.82 m ²
Roof area	≈ 8.90 m ²
Roof panel	Normal extruded WPC panel / PP panel
Thickness of the Roof panel	16 mm
Roof angle	21°
Front, Side, Back overhang	58 cm, 30 cm, 22 cm
Door,	1 x 1500 x 1960 mm
Opening size	1372 x 1832 mm
Window	2 x 400 x 210 mm
Pallet	2900 x 1120 x 630 mm

XF-H012

2805x2005x2686mm

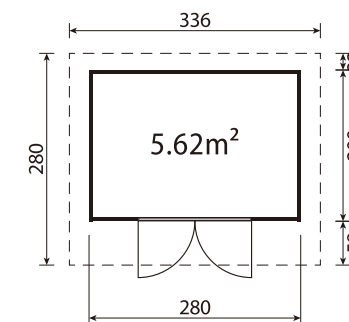
**Dimension:**

Wall panel	Co-extruded WPC panel / Normal extruded WPC panel / PP panel
Thickness of the wall panel	28 mm
Wall height	≈ 214 / 268 cm
Ridge height	≈ 266 cm
Floor area	≈ 5.62 m ²
Roof area	≈ 10.0 m ²
Roof panel	Normal extruded WPC panel / PP panel
Thickness of the Roof panel	16 mm
Roof angle	21°
Front, Side, Back overhang	58 cm, 28 cm, 22 cm
Door,	1 x 1500 x 1960 mm
Opening size	1372 x 1832 mm
Window	2 x 400 x 210 mm
Pallet	2900 x 1120 x 630 mm

XF-H013

2805x2405x2686mm

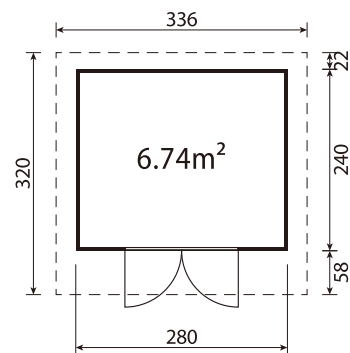
**Dimension:**

Wall panel	Co-extruded WPC panel / Normal extruded WPC panel / PP panel
Thickness of the wall panel	28 mm
Wall height	≈ 214 / 268 cm
Ridge height	≈ 266 cm
Floor area	≈ 6.74m ²
Roof area	≈ 11.45 m ²
Roof panel	Normal extruded WPC panel / PP panel
Thickness of the Roof panel	16 mm
Roof angle	21°
Front, Side, Back overhang	58 cm, 28 cm, 22 cm
Door,	1 x 1500 x 1960 mm
Opening size	1372 x 1832 mm
Window	2 x 400 x 210 mm
Pallet	3300 x 1120 x 630 mm

XF-H015

2885x5195x2850mm

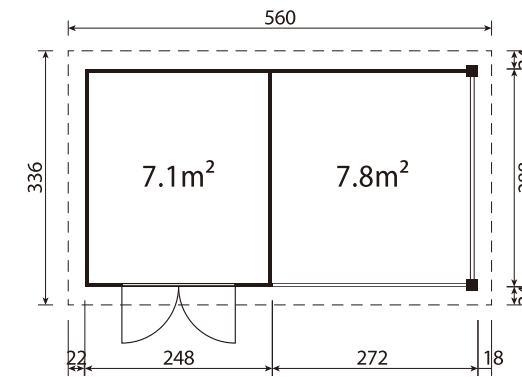
**Dimension:**

Wall panel	Co-extruded WPC panel / Normal extruded WPC panel / PP panel
Thickness of the wall panel	28 mm
Wall height	≈ 214 / 282cm
Ridge height	≈ 285 cm
Floor area	≈ 14.9 m ²
Roof area	≈ 18.4 m ²
Roof panel	Normal extruded WPC panel / PP panel
Thickness of the Roof panel	16 mm
Roof angle	21°
Front, Side, Back overhang	24 cm, 22 / 18 cm, 24 cm
Door,	1 x 1500 x 1960 mm
Opening size	1372 x 1832 mm
Window	1 x 900 x 506 mm 2 x 400 x 210 mm
Pallet	3400 x 1120 x 850 mm

XF-H014

2805x2805x2686mm

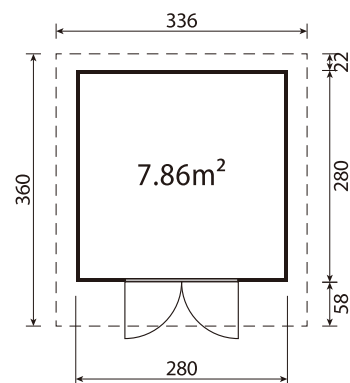
**Dimension:**

Wall panel	Co-extruded WPC panel / Normal extruded WPC panel / PP panel
Thickness of the wall panel	28 mm
Wall height	≈ 214 / 268 cm
Ridge height	≈ 266 cm
Floor area	≈ 7.86 m ²
Roof area	≈ 12.88 m ²
Roof panel	Normal extruded WPC panel / PP panel
Thickness of the Roof panel	16 mm
Roof angle	21°
Front, Side, Back overhang	58 cm, 28 cm, 22 cm
Door,	1 x 1500 x 1960 mm
Opening size	1372 x 1832 mm
Window	2 x 400 x 210 mm
Pallet	3700 x 1120 x 630 mm



XF-H016

2885x5595x2850mm

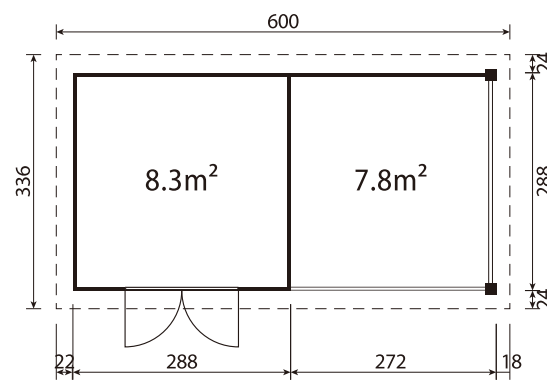
**Dimension:**

Wall panel	Co-extruded WPC panel / Normal extruded WPC panel / PP panel
Thickness of the wall panel	28 mm
Wall height	≈ 214 / 282cm
Ridge height	≈ 285 cm
Floor area	≈ 16.1 m ²
Roof area	≈ 19.8 m ²
Roof panel	Normal extruded WPC panel / PP panel
Thickness of the Roof panel	16 mm
Roof angle	21°
Front, Side, Back overhang	24 cm, 22 / 18 cm, 24 cm
Door, Opening size	1 x 1500 x 1960 mm 1372 x 1832 mm
Window	1 x 900 x 506 mm 2 x 400 x 210 mm
Pallet	3400 x 1120 x 850 mm

XF-H017

2005x2005x2327mm

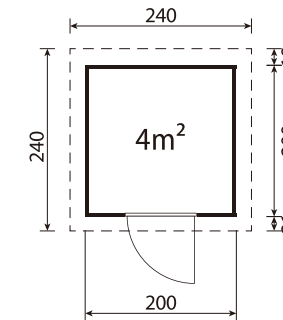
**Dimension:**

Wall panel	Normal extruded WPC panel
Thickness of the wall panel	19 mm
Wall height	≈ 214 / 229 cm
Ridge height	≈ 232 cm
Floor area	≈ 4.0 m ²
Roof area	≈ 5.76 m ²
Roof panel	Normal extruded WPC panel / PP panel
Thickness of the Roof panel	16 mm
Roof angle	4°
Front, Side, Back overhang	21 cm, 20 cm, 19 cm
Door, Opening size	1 x 950 x 1960 mm 822 x 1832 mm
Window	1 x 500 x 210 mm
Pallet	2500 x 1120 x 500 mm

XF-H018

2005x2005x2533mm

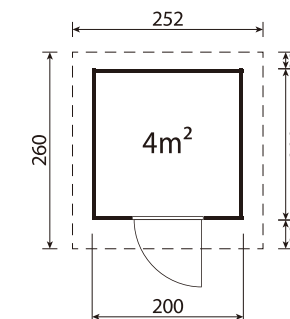
**Dimension:**

Wall panel	Normal extruded WPC panel
Thickness of the wall panel	19 mm
Wall height	≈ 214 / 250cm
Ridge height	≈ 253 cm
Floor area	≈ 4.0 m ²
Roof area	≈ 6.96 m ²
Roof panel	Normal extruded WPC panel / PP panel
Thickness of the Roof panel	16 mm
Roof angle	21°
Front, Side, Back overhang	38 cm, 26 cm, 22 cm
Door, Opening size	1 x 950 x 1960 mm 822 x 1832 mm
Window	1 x 500 x 210 mm
Pallet	2700 x 1120 x 520 mm

